

maars | styleline

Create your environment



Whenever and wherever an interior space has to a be divided, Maars is a partner you can trust to turn your plans into reality, for projects large or small, be they purely functional or luxuriously innovative.

When you talk to us, you are talking directly to the manufacturer. Just tell us what you want, and we will have the perfect solution. Or we will work with you to develop and produce it. In other words, 'Create your environment'.

Maars has many years of experience in a multitude of different projects, nationally and internationally. Most of all, Maars is there to help translate your ideas into practical, flexible, aesthetically pleasing interiors, where it is a pleasure to live and work.

Maars styleline. Probably the most frequently used partition system in Europe. Why? Because, quite simply, no other system can be so easily adapted to the customer's wishes and requirements.

The styleLine series represents the ultimate in flexibility and versatility, whatever the budget and whatever the building situation.

Maars styleline | standard. Simple. Economical. Functional. Available in standard modules for applications such as basic, practical offices in industrial surroundings.

Maars styleline | variant. Brings a new meaning to versatility with limitless permutations of wall layouts, module widths, thicknesses, glass, door and cupboard elements, colours, insulation properties, etc. A truly universal system for a wide variety of projects.

Maars styleline | finesse. The crème de la crème of partitioning systems in the styleline range providing a smooth, flawless finish with elegant detail, and, of course, like all the styleline range, finesse is simplicity itself to move and reuse.



10

Montreal Tower

www.maarsgroup.com



High-quality materials. Perfect craftsmanship. Just because styleLine partition walls are the most economical in the Maars range, this certainly does not mean that we have made concessions on quality. Nothing could be further from the truth. This partition system also uses high-quality materials and techniques to produce partition walls that satisfy the highest standards, even when the budget is tight.

For instance, in our advanced spraying-plants, all visible metal components are given an extremely durable, attractive polyester-epoxy coating in your choice of colour. For wallcovering, you can choose from a wide range of materials, colours and designs.

Create your environment





Create your environment



ROC
Rijks Hogeschool
van
Oost-
Vlaanderen

- 3
- 2
- 1
- 0g
- 1

Teleport

If your budget stretches to it, you can achieve spectacular results with real wood veneer, special glasses, matt glass, designer door-handles... and many other extras to lend your wall system that touch of exclusivity. As always, Maars will be on hand to help you with advice on how to make your project truly exceptional.

the concept of human scale

style

Create your environment

14.07

eline



Create your environment



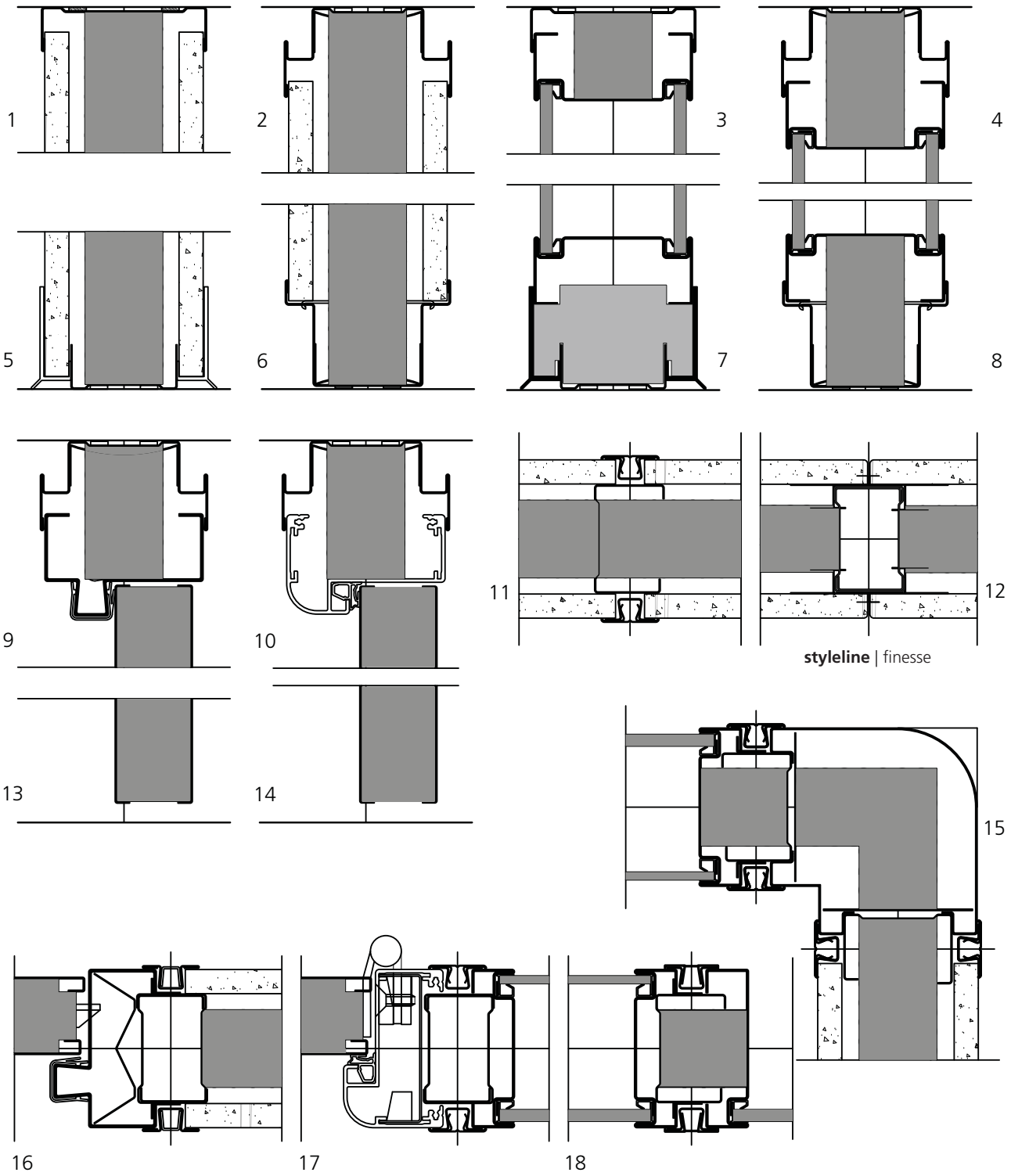

styleline | finesse

styleline | standard

styleline | variant

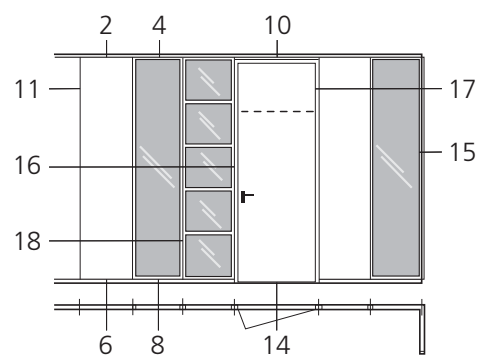
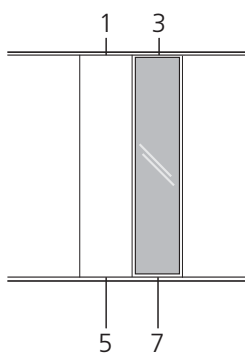

Create your environment



Maars styleline partitioning systems

FRAME Galvanized steel studs and cross profiles.

SKIRTING Recessed steel floortracks or PVC skirting.

HEADTRACKS Recessed or flush channel steel sections. Picture hooks can be hung from the recessed head tracks.

PANELS 12,5 mm plasterboard or chipboard. 2, 3 or 4 panels possible.

GLASS ELEMENTS Single or double-glazed metal frames, different section forms. Several types and thicknesses of glass available.

DOOR ELEMENTS Metal frames with square, rounded or elliptical corners for standard or floor-to-ceiling height doors, suitable for Maars metal doors. Wooden, fully glazed and sliding doors are also available.

PANEL JOINING STYLELINE FINESSE V-shaped joins without visible connectors, styleline variant powder-coated steel omega profiles with plastic infills, styleline standard galvanized steel omega profiles with plastic cover strips.

MODULE WIDTH Up to 1200 mm with vertical divisions and up to 1800 mm in the case of horizontal divisions. Other dimensions possible on request.

PARTITION HEIGHT Up to 3000 mm, other heights possible on request.

PARTITION THICKNESS 82 mm with single cladding, 107 mm with double cladding.

WEIGHT Solid modules approximately 28 kg/m² for single panelled to approximately 48 kg/m² for double panelled partitions.

FINISHES AND COLOURS Metal partition elements, including the Maars metal doors, are finished with a polyester-epoxy powder coating in satin or soft touch in one of our RAL colours. PVC components are also available in a number of RAL colours. Partition cladding finished with vinyl, textile, veneer or melamine. Wooden doors are laquered, veneered or laminated.

SERVICES Services can be installed either horizontally or vertically and easily accessed for maintenance or future alteration.

ACCESSORIES Cupboard units, ticket and sliding window units, Venetian and vertical blinds within the sealed glass elements, picture hooks etc.

SOUNDINSULATION Single panelled partitions up to Rw 42 dB, double panelled partitions up to Rw 49 dB. Test reports available on request.

FIRE RESISTANCE Solid panelled partitions from 30 minutes up to 60 minutes, window units up to 30 minutes, door units up to 30 minutes. Test reports available on request.

We will be happy to talk to you about special versions such as partitions made from different materials, particular colours, custom finishes etc.



Maars styleline finesse, - variant and - standard are registered trade marks of Maars Holding BV. Subject to alterations.



Create your environment

+31(0)341 46 52 11
www.maarsgroup.com

E